

# Ethernet Terminal

## Universal Recording Terminal



### Versatile terminal device for virtually any application

This multifunctional network terminal device has been specially designed for direct data acquisition, clocking in/out and data retrieval. The all-purpose Ethernet terminal can be connected to any server directly via its Ethernet interface. Each terminal enables both automatic data collection (AIDC) such as counting, monitoring, and alerting as well as manual operation, for example, confirmation, explanations, and added entries. Terminal dialogs can be configured in such a way that one model can meet the needs of diverse applications ranging from the acquisition of production and machine data to time and attendance recording or computer-aided quality assurance.

The versatile Ethernet terminal is supported by configurable dialog systems and thus covers a whole range of multiple applications from production data acquisition (PDA), machine data acquisition (MDA), and attendance recording through to quality assurance (CAQ), access control systems, and time recording.

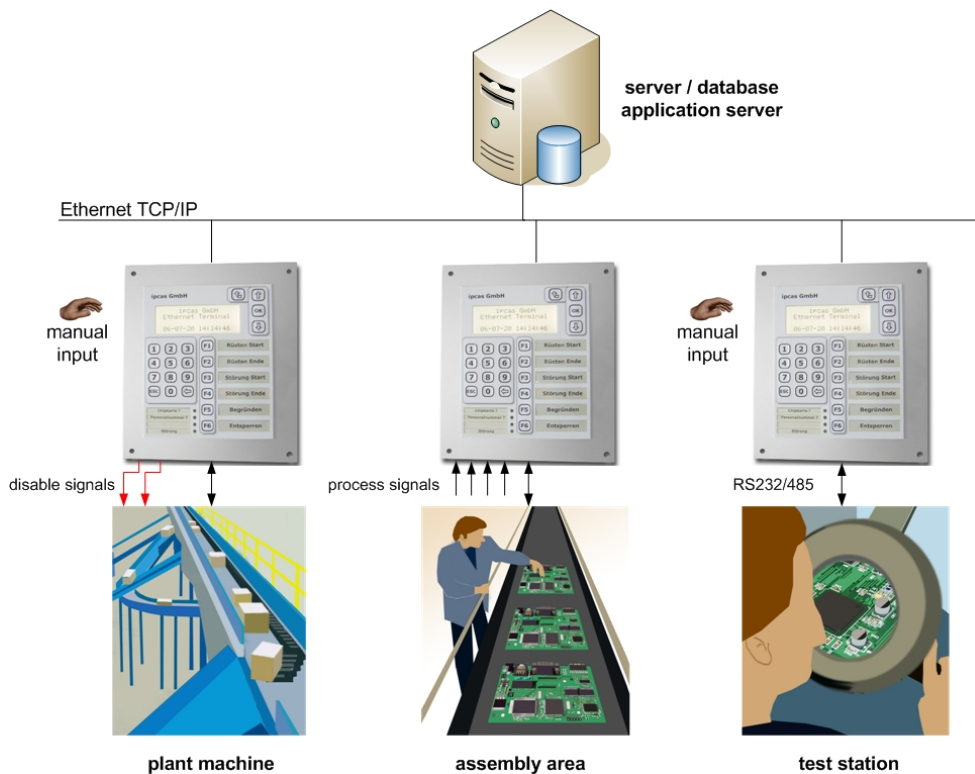

The bright 4 line display is background-lit and, therefore, easy to read. People, orders, etc. can be signed in or out either manually with the membrane keypad, or automatically using the integrated RFID reader. The Ethernet terminal has four digital inputs for signal acquisition and two relay outputs for signal control. Additional devices (barcode reader, label printer, measuring and test devices) can be connected through the serial RS232/485 interface. The Ethernet interface enables easy integration of the Ethernet terminal into PC networks.

Conventional RS 485 infrastructure and additional master terminals are no longer required, which greatly reduces setup costs and, at the same time, speeds up data communication.

All applications are programmed with XML technology in a PC environment and run on a central server, which facilitates administration substantially.

If you do not want to develop your application by yourself, ipcas also provides software solutions such as FAMOUS.Base.

# Ethernet Terminal Universal Recording Terminal

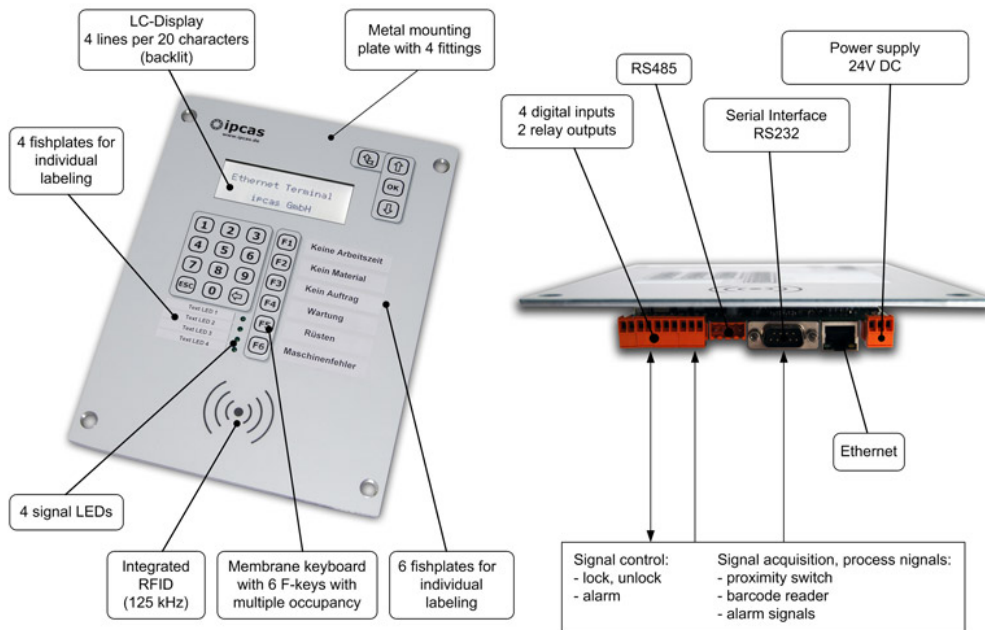

## Specification

Ethernet Terminal	Panel-mounted version
LCD display	4 lines, 20 characters, background-lit display
Membrane keypad	6 function keys, keys and number pad for manual entry
RFID reader	125 KHz
Transponder type	EM 4102
Interfaces	<ul style="list-style-type: none"> <li>➤ 1 x RS232 SUB D9 male (RX / TX / GND)</li> <li>or (RX / TX / RTS / CTS / DTR / DSR / GND)</li> <li>1x RS485 3.5 mm female header (2 wire)</li> <li>➤ 1 x 10BaseT / 100BaseTX Ethernet, RJ45 female</li> <li>➤ 4 x 24 V DC input channel</li> <li>➤ 2 x Relay output channels 24 V/1A</li> <li>➤ Separate channels: 500 V, galvanic insulation</li> <li>➤ Isolation voltage: 1.5 kV</li> <li>➤ Input scan cycle: 1 to 255 ms</li> <li>➤ Input debouncing: 1 to 15 fold scan cycle</li> <li>➤ Baud rate: 300 to 115,200 bauds</li> <li>➤ Parity: None, even, odd, mark, space</li> <li>➤ Data: 8 bits</li> </ul>
Diagnostics LEDs	Link, Act
Terminal status LEDs	4 Signal LEDs, freely programmable
Voltage supply	24 V DC <sup>1)</sup> 3.5 mm female header (Voltage range 10 - 36 V DC)
Mounting plate W/H/D	Aluminium, approx. 165 / 170 / 3 mm
Measurements (electronics) W/H/D	Approx. 113 / 160 / 28 mm
Operating/Storage temperature	5° C to 55° C / -10° C to 70° C
Relative humidity	5 % to 90 %, non-condensing
Protection rating	IP54, front panel
Standards	CE
Scope of supply	Panel-mounted Ethernet terminal w/o power supply (optional) Configuration software Manual on CD (English and German)
Purchase order number	0202028

<sup>1)</sup> Other voltages on request